



**KENEKAR**  
**ENGINEERS**

KENEKAR



TOTAL SOLUTION FOR  
**CONSTRUCTION**  
EQUIPMENT

📞 9225532555, 9370219239

📍 GAT No. 847, Barge Wasti,  
Chimbali, Khed, Pune 410501

✉ kenekarengineers@gmail.com

GST NO. 27AZSPK0340C1ZL

**M.S. Heavy Fabrication Works, Centering & Const. Equipment**

## Roll Threaded Adjustable Steel Props

These are made of 40 mm NB inner pipe which moves telescopically in the outer pipe of 50 mm NB

The tubes conform to IS : 1161. YST 210 Grade of Medium class. Outer 58.3 mm OD and Inner 48.3 mm OD. Beyond 3.6m height, inner tube is to be braced in both directions after the threaded and of outer tube by Double Couplers. Heavy Duty Cast Iron malleable Nuts are used. They are available in Stirrup Head, Flat plates or Beam head. Beam head is a separate attachment.

### Roll Threaded Outers

Roll Threaded cutter is a recent innovation in scaffolding industry. Which has replace cut-thread process. In rolled threading method excess material is pressed in the pipe thus preventing wastage of material. There by increasing its load taking capacity. These are made from 50NB tubes of special grade as per IS standards



## H Frame Scaffolding with Zig Zag Ladder



Ideal as access scaffolding and support centering. Consists of welded frames with two verticals with sockets welded to them & two 40/20 mm N.B. horizontals. Frames manufactured in heights of 2000, 1250 & 1000 mm & width 1800 mm & 1000 mm

Scissor type cross bracing secured to frames through the pins welded to frames & locked in position by gravity locks. Cross bracings manufactured are of heavy duty angles

### Types of Frames

Walk Thru, Ladder and other frames also available in all specification. These are sturdy welded frames with two verticals and two horizontals connections done by scissor cross braces through welded pins and locked by spring clips / Gravity lock pins.

### Frames for Tower Hoist / Lift Machine :

Manufactured from 40/32 NB tubes specification followed are standard as per the winch of the hoist. Size 2000 mm height and 2000 mm width, ladder is given as per order. These H-Frames come in set of 40/30 m height. Heavy duty angular cross bracing are made to maintain distance of 2000 mm between two frames

### as per IS Standard

40 NB Tubes are available as per IS 1239 Medium class very commonly used for bracing of props having opening more than 3.5 m or also used for bracing H-Frames or supporting of structures / slab using stirrup head at top



## 40 NB Bracing Tubes



## Cuplock Systems

This is a multi purpose system which is used for plastering, supporting structures, for lift machine (Hoist) etc. This system can be erected for straight circular & also curved structures. This system has horizontal & vertical members. Horizontal members are locked to vertical members by cup provided on it. The cups on the vertical members are of malleable cast iron and pipes used are of 40 NB pipe, forged blades are welded on both corners

### Horizontals :

Horizontals have identical forged blade ends with minimum of projection to avoid damage. Each component locates in the cup joints on the vertical

#### Specification :

| Product Code | Length c / c | Weight |
|--------------|--------------|--------|
| K805         | 2.0 m        | 6.8 kg |
| K806         | 1.2 m        | 4.0 kg |
| K807         | 1.5 m        | 5.0 kg |

Note : Pipe as per BS 4360 N.B.M.S. Pipe OD 48.3 mm. Wall thickness 2.9 mm, Weight 3.25 Kg/m forged blade grade '2' on other side. As per requirement Adjustable Horizontals are tailor made.

### Verticals :

Vertical are provided in four basic sizes with cup joints welded at 500 mm intervals. The captive top cups are of malleable casting to endure rough site handling and welded bottom cups are pressed from high - quality steel.

#### Specification :

| Product Code | Length c / c | Weight   |
|--------------|--------------|----------|
| K801         | 3.0 m        | 14.97 kg |
| K802         | 2.5 m        | 12.97 kg |
| K803         | 2.0 m        | 10.00 kg |
| K804         | 1.5 m        | 7.4 kg   |

Note : Pipe as per BS 4300 / IS 161-40 N.B. Class - 'B' O.D. 48.3 mm, Wall thickness 2.9 mm : wt. 3.61 kg./m, as per grade YST - 22/24, Tolerance as per 1.5.1

**Top Cup** - Malleable cast iron 3 lug./4 lug.

**Bottom cup** - Made out of 4 mm press metal

### U-head & Base Jack

For traditional timber support. Designed to use with a timber of 75 mm Nominal width 600 mm long screw jack is used in connection with a U - head.

**Note :** JACK in a made 38 mm OD hollow pipe (full threaded) with malleable cast iron unit U is welded to the jack. Also available as separately units U head & Jackrod.

U head are provided with proper nailing provision



Cuplock System

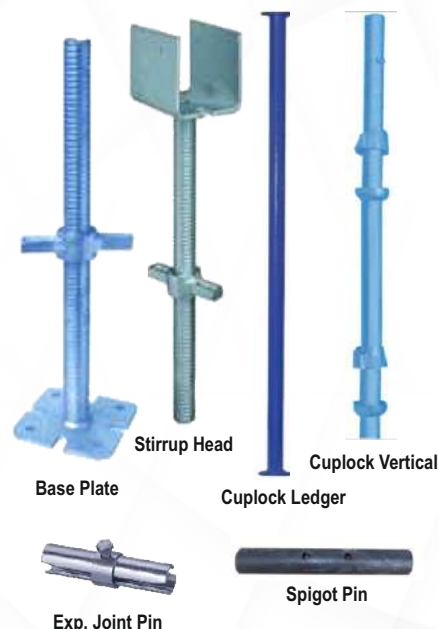

**U-Cup Size :** 100 x 75 x 100 x 6mm

**Base Plate Size :** 150 x 150 x 6 mm

**Base Jack Size :** 350 mm to 900 mm long

**U Jack Size :** 350 mm to 900 mm long

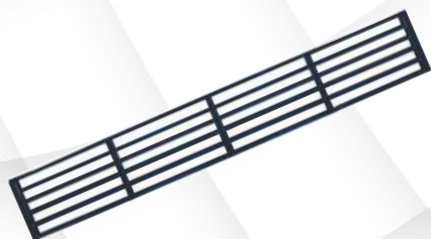

## MS - Walkway Planks

Manufactured of 25 x 25 x 1.6 mm thick square tube CO2 welding is used for high quality welding strength and durability. These planks are painted with oxford blue paints.

**Size :** 1 ft x 8 ft  
1 ft x 10 ft

## Safety Net Bracket

### Slab Type

Manufactured from 35 x 35 x 5 mm angle & 2.5 mm sheet.  
Top clamp of 50 x 5 mm flat is welded at the top of the bracket.

### Beam Type

Manufactured from 35 x 35 x 5 mm angle & 2.5 mm sheet.  
Top clamp of 50 x 5 mm flat is welded at the top of the bracket.



Slab Type

Beam Type

## Cantiliver Bracket

Manufactured of 50 x 50 x 2.5 mm thick square tube.  
Cantiliver Bracket is an economic, durable & easy to use system that provides a safe and versatile solution to climbing vertical shuttering support & protected working area that is ideal for high structures



## Waller Clamp



Waller's are Manufactured in ISMC 75 x 75 x 40 mm and 20 mm square bar. These are also manufactured in square tubes.  
Size as per requirement

## Adjustable Box Span

Manufactured from  
Outer : 72 x 72 x 3 mm square tube  
Inner : 60 x 60 x 3 mm square tube  
Angle 65 x 6 mm thick with Bolting provision

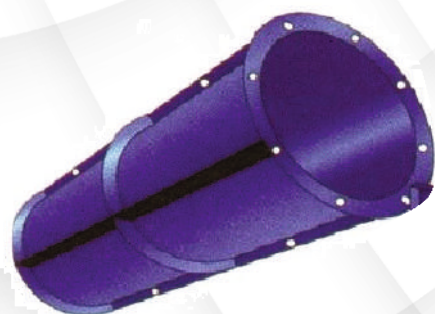

## Column Farma

These farma are manufactured using MS Sheet and Angle with heavy stiffener support and are offered in various sizes. These farma are CO2 welded for high strength. These farma helps to give excellent finish to the columns after the casting